

### SeaStar Solutions Engine Connection Kits

These kits provide control cable connection hardware, either for cable to engine/transmission or for cable to control unit. Most are specific to engine or control type and for use with two 3300 type cables, except where otherwise noted.

\*1 kit required for each cable

#### STR CA28020P

Clamp & Shim kit universal



#### STR CA27321P

Evinrude/Johnson O/B Kit (Pre 1979)



#### STR CA27319P

Mercury stern drive kit (all)

### SeaStar Universal Connection Kits

#### STR CA37701P

Universal 3300 Ball Joint 1/4"-28 (1)



#### STR CA27328P

Parallel Connection Kit

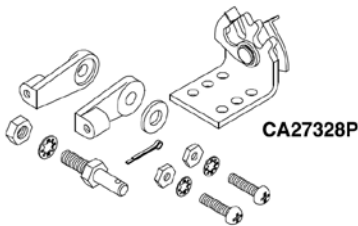

#### STR CA27024P

Universal Inboard Connection Kit



### SeaStar Solutions CH5600 Control Connection Kit

#### STR CA69022P

Cable attachment kit (3300/33C Dual station)

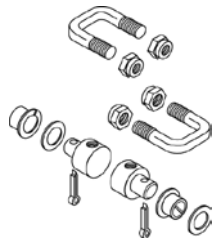

### SeaStar Solutions Kit - Clamp To Bulkhead

#### STR 304307

30 Series



### SeaStar Solutions DC Control

Designed to mount flush on a dashboard or side of a wheel box. Mounting with an angle bracket is optional. Recommended for throttle, choke, air or fuel shutdown, governor or valve control. Use with 33C series cables.



#### STR 301916

DC control

#### STR 301555

T-Handle only

### SeaStar Solutions Mounting Bracket

All stainless steel angle mounting bracket for use with the DC control.

#### STR 48210



### SeaStar Solutions Parts - Control Connection Kits

These kits adapt 3300/33C series cables for use with other controls.

#### STR 301074

Adapts 3300/33C series cables for use with Mercury/Mariner controls



301074

#### STR 304939

Adapts 3300/33C series cables for use with 1979 and later OMC Controls.



304939

### SeaStar Solutions Parts - Engine Connection Kits

These kits are used to adapt 3300/33C series cables to fit directly into the existing engine connections.

#### STR 301729

Adapts 3300/33C series cables for use with Evinrude/Johnson 55-235 h.p. 1978 to date, 20 h.p. and up in 1986, 20-25-30 h.p. motors may need OMC Kit 397488, if motor does not have it installed already.



301729

#### STR 302123

Adapts 3300/33C series cables for use with Mercruiser.



302123

### SeaStar Solutions Parts - Accessories



61342



300673



302485



37693

#### STR 41884-01A

T-Handle, black plastic, 10-32

#### STR 41884-01B

T-Handle, black plastic, 1/4"-20

#### STR 61342

T-Handle hardware kit

#### STR 300673

30L Bulkhead adaptor kit

#### STR 302485

30L Clamp adaptor kit

#### STR 37693

30L Stop collar

#### STR 294200-001

30 Series isolator kit



294200-001

► **Note**

30 Series ..... 10-32 RH Thread  
 40 Series ..... 1/4"-28 RH Thread  
 60 Series ..... 5/16"-24 RH Thread

### SeaStar Solutions Parts - Cable Hook Clips

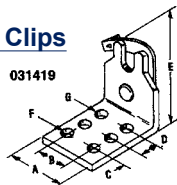

#### 30 Series Single

Part #	A	B	C	D	E	F	G
<b>STR 31419</b>	1"	1/2"	3/8"	1/2"	1-3/16"	1/4"	3/16"

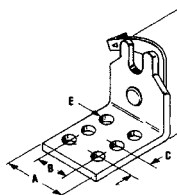

#### 30 Series Single

Part #	A	B	C	D	E
<b>STR 36174</b>	1-1/4"	3/4"	3/8"	1-1/2"	13/64"

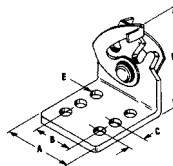

#### 30 Series Dual

Part #	A	B	C	D	E
<b>STR 35531</b>	1-1/4"	3/4"	3/8"	1-1/2"	13/64"

### SeaStar Solutions Parts - Clevis

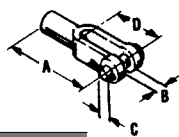

#### 30 Series

Part #	A	B	C	D
<b>STR 31125</b>	2"	9/32"	1/4"	1-1/4"
<b>STR 31800</b>	1-9/16"	3/16"	3/16"	1"
<b>STR 33395</b>	2-1/4"	17/32"	11/16"	5/16"

#### 40 Series

Part #	A	B	C	D
<b>STR 29025</b>	2"	9/32"	1/4"	1-1/4"
<b>STR 42212</b>	2-1/4"	11/32"	5/16"	1-7/16"
<b>STR 45985</b>	2 -2"	7/16"	5/8"	1-5/8"

#### 60 Series

Part #	A	B	C	D
<b>STR 29132-001</b>	2-1/4"	11/32"	5/16"	1-7/16"
<b>STR 42034</b>	2-1/4"	11/32"	5/16"	1-7/16"

### SeaStar Solutions Parts - Cable Brake

Part #	A	B	C
<b>STR 44386</b>	3/4"	1-1/4"	7/8"

Cable brake fits 30,40 & 60 series cables.

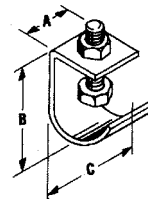

### SeaStar Solutions Parts - Clamps

#### 30 Series

Part #	A	B	C
<b>STR 32010</b>	7/8"	1/2"	3/16"

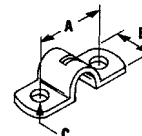

#### 30 Series

Part #	A	B	C	D	E
<b>STR 31509</b>	3/8"	1"	1-1/2"	1/2"	12/64"

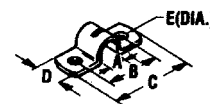

#### 40 Series

Part #	A	B	C	D	E	F
<b>STR 31532</b>	1/2"	1"	1-1/2"	1/2"	7/32"	N/A
<b>STR 42756</b>	31532 & 31538 Shim					

#### 60 Series

Part #	A	B	C	D	E
<b>STR 36733</b>	9/16"	1-1/4"	1-3/4"	5/8"	9/32"

#### 30L Series (No Hub)

Part #	A	B	C	D	E	F
<b>STR 37664</b>	1/4"	1"	1-1/2"	1-1/4"	3/4"	7/32"

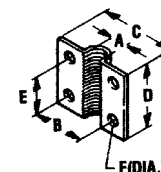

#### 40 Series

Part #	A	B	C	D	E	F
<b>STR 21227</b>	1/2"	1"	1-1/2"	1-1/4"	3/4"	7/32"

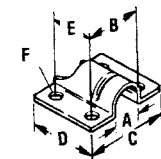

#### 30 Series Clamp Bracket

Fits over 1/2" rod. For use with clamps, 31509, 37664, 21227 and shim 31538.

**STR 21600**



### SeaStar Solutions Parts - Shims

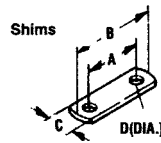

Part #	A	B	C	D
<b>STR 35777</b>	7/8"	1-3/8"	1/2"	12/64"
<b>STR 37884</b>	1-1/4"	1-3/4"	5/8"	9/32"
<b>STR 31538</b>	1"	1-1/2"	1/2"	12/64"

### SeaStar Solutions Parts - Ball Joints

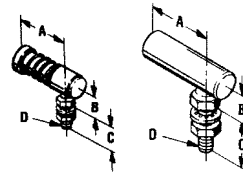

#### 30 Series

Part #	A	B	C	D
<b>STR 31126</b>	31/32"	15/32"	9/16"	1/4-28"
<b>STR 31799-001</b>	29/32"	15/32"	7/16"	10/32"
<b>STR 35242</b>	1-1/8"	17/32"	7/8"	5/16"

All units come complete with nut and lock washer.

#### 40 Series

Part #	A	B	C	D
<b>STR 29104</b>	31/32"	15/32"	9/16"	1/4-28"
<b>STR 32267</b>	29/32"	17/32"	7/8"	5/16"

Both units come complete with nut and lock washer.

#### 60 Series

Part #	A	B	C	D	Style
<b>STR 29108</b>	1-1/8"	17/32"	7/8"	5/16"	Quick Release
<b>STR 38491</b>	1-1/8"	17/32"	7/8"	5/16"	Solid Type

Both units come complete with nut and lock washer.

### SeaStar Solutions - Terminal Eye Pins

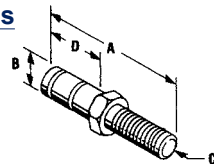

#### 30 Series

Part #	A	B	C	D
<b>STR 300965</b>	1-1/2"	5/16"	1/4"-28	19/32"
<b>STR 301456*</b>	1-1/2"	5/16"	1/4"-28	19/32"

\*Note: 301456 Pin Kit Includes eye pin, retaining ring, nut & washer.

### SeaStar Solutions Parts - Pivots

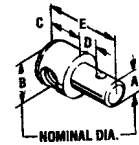

#### 30 Series

Part #	A	B	C	D	E
<b>STR 31029</b>	1/4"	7/16"	21/64"	9/64"	5/8"
<b>STR 31539</b>	1/4"	7/16"	3/8"	.191"	23/32"
<b>STR 32392</b>	1/4"	7/16"	21/64"	.295"	25/32"
<b>STR 37691</b>	5/16"	7/16"	3/8"	13/32"	1-1/16"
<b>STR 39890</b>	1/4"	7/16"	3/8"	.316"	15/16"
<b>STR 45583</b>	3/16"	7/16"	3/8"	9/64"	1-1/16"

#### 40 Series

Part #	A	B	C	D	E
<b>STR 31537</b>	1/4"	1/2"	1/2"	13/64"	7/8"
<b>STR 36361</b>	1/4"	1/2"	1/2"	17/64"	15/16"
<b>STR 39110</b>	1/4"	1/2"	7/16"	9/64"	3/4"

### SeaStar Solutions Parts - Terminal Eyes

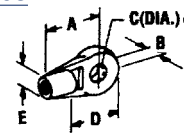

#### 30 Series

Part #	A	B	C	D	E	
<b>STR 300646</b>	1"	15/64"	5/16"	3/4"	1/2"	Plastic
<b>STR 317413</b>	-	-	5/16"	-	-	Metal

#### 40 Series

Part #	A	B	C	D	E
<b>STR 37639</b>	1"	15/64"	5/16"	3/4"	1/2"
<b>STR 41134</b>	1-3/8"	5/16"	5/16"	3/4"	1/2"

### SeaStar Solutions Dual Station Transfer Unit

For use with S and SR two lever control systems when installed in a parallel dual station system. The Transfer Unit permits the two clutch and/or the two throttle cables from the controls to be connected to a single cable leading aft to the engine. These units are recommended where long or difficult cable paths make parallel installations costly and/or difficult to operate. One transfer unit is required for each function of each engine.



**STR 61371**



**SeaStar Solutions  
"JBS" Jet Boat Steering**

Designed exclusively for Jet boats featuring a choice of two steering arc angles 135° or 270° lock to lock. Recommended for use in all jet boat applications powered by Mercury Sport Jet or OMC Turbo Jet drives up to 175 HP. NOTE - Can not be used on outboards with jet lower units.

- Ultra-compact helm with stylish 4.4" bezel is easy to install and very rugged
- 135° or 270° turning arc lock-to-lock
- Uses a special steering cable
- 90° dash mount. (Tilt Steering option available!)
- 90° or 180° cable entry into helm allows alternate cable routing. (Looking at dash, options are 9:00, 12:00 or 3:00 routing positions.)
- Built-in steering stops prevent additional cable stress in hard over positions
- Standard 3/4" round tapered steering shaft, 3.5" total allowable cable travel
- Mercury® & OMC® nozzle/gate connection kits
- Stainless steel cable output ends
- Meets A.B.Y.C./N.M.M.A. requirements
- Uses SSC219XX steering cable measured from end to end

- STR SH5087P** 135° helm
- STR SH5088P** 270° helm
- Accessories:
- STR SB39452P** Bezel & mounting hardware kit

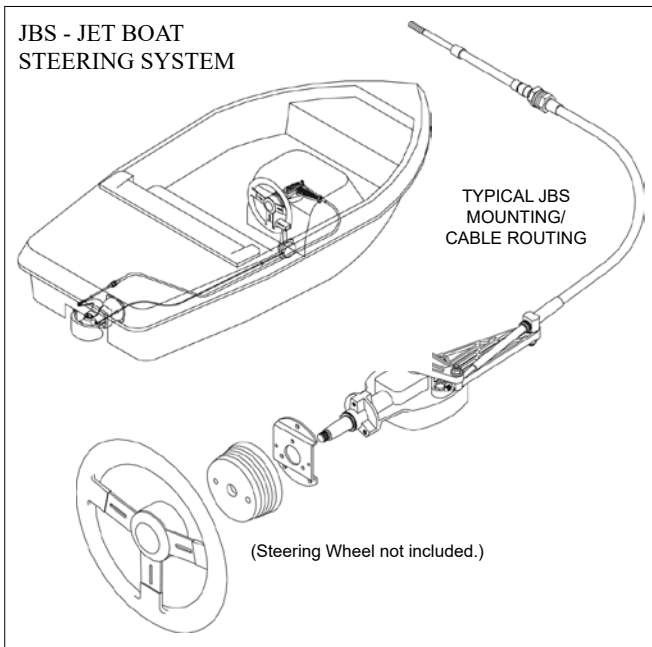

**SeaStar Solutions Big-T Helm**

Inboards to 34 feet with one engine. Also suitable for stern drive boats with power-assisted steering. Big-T systems accept steering wheels up to 20" diameter.

- Heavy duty helm
  - 3 turns lock-to-lock
  - Standard 3/4" tapered shaft
  - stainless steel cable outlet ends
  - Use SSC62 (\*See NOTE below) series cables
- \*\*Steering system is sold by components



- STR SH5000** Helm
- STR SA39329P** Cable gland
- STR SA27454P** Wheel hardware kit
- STR SA35680P** Spent travel tube
- STR SA27620P** Adapter

**Note** Adapter SA27620P required for SSC62XX cable installation

**SeaStar Solutions Safe-T TS (Old Style)**

- Large thread-on nut secures cable to helm
- Conical plastic nut holds spent travel tube

**STR SH5023P**



**SeaStar Solutions  
NFB Upgrade Helm**

Upgrade to NFB with just a helm. If the boat is equipped with Teleflex Morse Safe-T QC steering, you can upgrade to No Feedback just by swapping the helm. (cable must be a quick connect type).

**STR SH4910**



**SeaStar Solutions  
Steering Connection Kits**

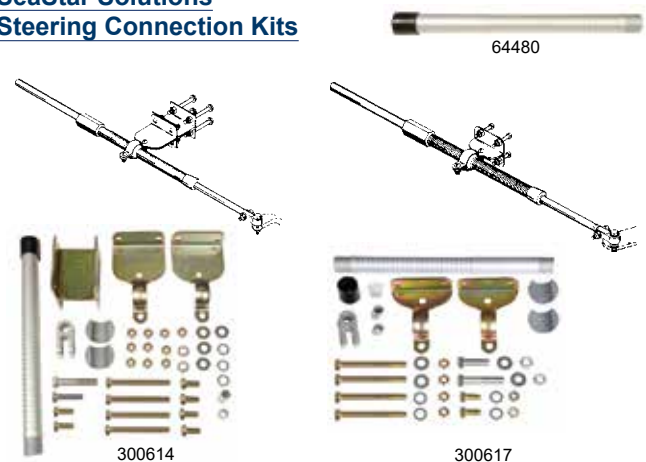

Most boats and engines are supplied complete with steering cable connection kits. Listed below are speciality kits which are available for Morse controls.

- STR 64480** Support tube, aluminum
- STR 300614** Inboard transom mount, Volvo, 1977 and earlier
- STR 300617** Inboard stand-off, short bracket 2"

## SeaStar Solutions Steering Connection Kits

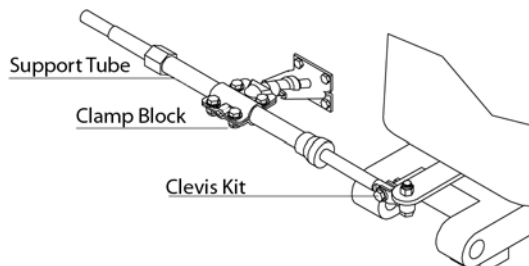

### Clamp Blocks

- Outboards

**STR SA27149P**

Stainless steel

**STR SA27055P**

Corrosion resistant



### Support Tubes

**STR SA27274P**

Aluminum

**STR SA27275P**

Stainless steel



### Clevis Kits

**STR SA27314P**

With short bolt

**STR SA27329P**

With long bolt



### Splashwell Mount Kit

- 15° (corrosion resistant)

**STR SA27253P**

**STR SA37868P**

Rubber boot only

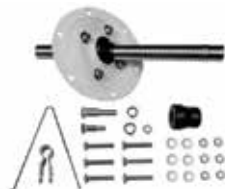

### Splashwell Mount Kit

- 90° (corrosion resistant)

**STR SA27254P**

**STR SA37868P**

Rubber boot only

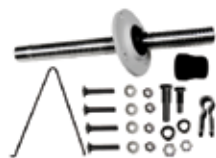

### Link Arm Kit

- With boot
- 1977-1984 Johnson/Evinrude 70&140 h.p. engines

**STR SA27361P**



### QCII Helm Converter

For helms with threaded spigots. Upgrades older SeaStar rotary helms to Quick-Connect cable interface, allowing use of SSC61/SSC62 QC cables

**STR SA27620P**



### Cable Gard

- For Most Outboards with Tilt Tube

**STR SA39329P**



## SeaStar Solutions 290 Steering Bezels

Available components and service items for Morse mechanical steering systems are listed below.

**STR 308559**

90° Bezel for 290

**STR 308561**

20° Bezel for 290



## Davis Cable Buddy

Steering cable lubrication system

Includes:

- 7/8" x 14 thread stainless steel nut
- Max-Lube, 90ml (3 oz)
- Filler tube

- Fits most motors
- Virtually eliminates cable wear
- Will prevent freezing to -40°

**DIN 420**



## Davis Lube II

- Keeps moisture and contaminants out while enabling you to pour or pump several types of lubricant in
- Allows steering rods to be easily lubricated
- Includes a stainless steel lubricating nut with an oil seal and a grease (zerk) fitting
- Works for both mechanical and hydraulic systems
- Fits all major US and foreign motors (7/8" x 14 pitch threads)
- Salt and fresh water use

**DIN 425**



## OMC Steering Cable Kit

To refit "external steer" systems.

Replaces obsolete steering cable with standard cable. Simply install a new standard helm kit in the boat and attach the ball and tube assembly at the transom.

**WES OMC-KIT**

